



Bedford Road, West Sussex, RH13 5BJ
Asking Price £210,000

& LINES
James

Bedford Road, Horsham

- NO CHAIN
- ONE BEDROOM
- BASEMENT MAISONETTE
- ALLOCATED PARKING
- CLOSE TO TOWN AND STATION
- COUNCIL TAX BAND B
- EPC RATING D
- LEASEHOLD

A unique one bedroom basement flat situated close to the station and town centre benefiting from allocated parking.

Location

The property is conveniently situated with half a mile of the town centre and mainline station, allowing all the towns amenities to be accessed on foot. By car the property provides easy access on the A281 connecting the road networks of the A24 and A23. Horsham is a thriving market town with a number of independent and high street retail shops, cafes and restaurants, as well as several supermarkets including a Waitrose/John Lewis.





Property

This one bedroom maisonette offers spacious accommodation with character features. The entrance to the property leads into the sitting room which features a decorative tiled fireplace, bay window with storage and shelving to the alcoves. An inner hallway creates an ideal study area. The kitchen is fitted in a range of white eye and base level units with complementing worktops and tiled floor. A spacious double bedroom features decorative fireplace and laminate wood flooring. The bathroom is light and airy and is fitted in a white suite with shower over the bath, a window provides natural light and ventilation. Additional features include Gas central heating and double glazing throughout.

Outside/Lease

The stairs leading to the property provide space to keep potted plants creating a pleasant approach. To the rear, the driveway leads to a communal area where there is an allocated parking space.

Lease

Leasehold - Approximately 87 years remaining

Maintenance charge - £80 per month

Agent's Note:

We strongly advise any intending purchaser to verify the above with their legal representative prior to committing to a purchase. The above information has been supplied to us by our clients/managing agents in good faith, but we have not necessarily had sight of any formal documentation relating to the above.



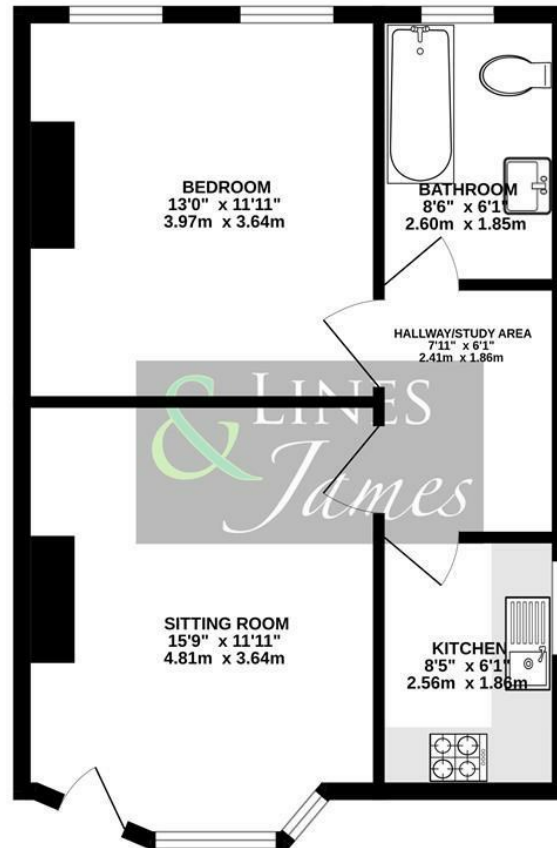

Measurements are approximate and not to scale. Bedroom measurements do not take into account the fitted wardrobes. This plan is for illustrative purposes only and should only be used as such by any prospective tenant. No responsibility is taken for any error, omission or mis-statement. Made with Metropix ©2026

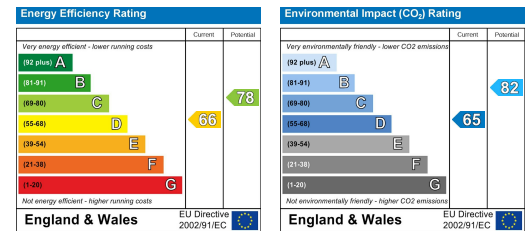
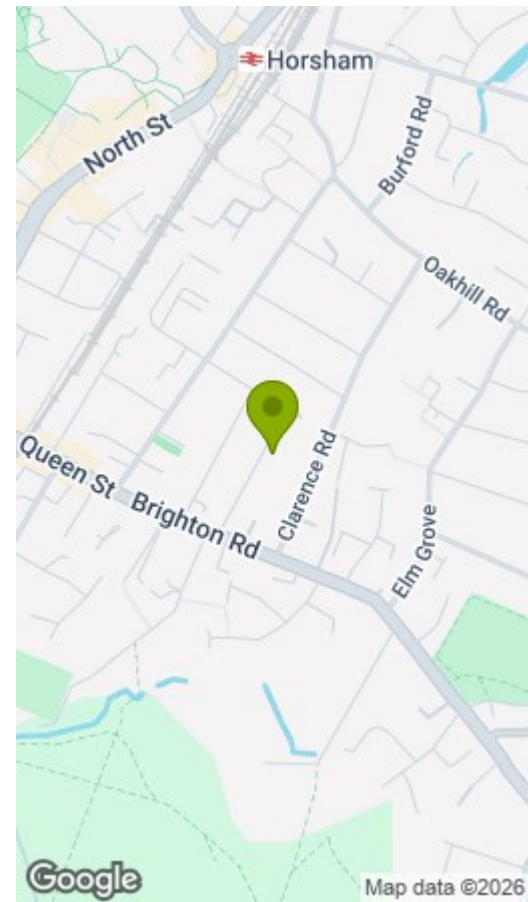

24 Worthing Road, Horsham, West Sussex, RH12 1SL,
Tel: 01403 210088
lettings@linesandjames.com
www.linesandjames.com

