



**North Parade, Horsham, RH12 2DD**  
**£1,050 Per Month**

**& LINES**  
*James*

# Sussex Lodge North Parade

- ONE BEDROOM
- GROUND FLOOR
- GOOD LOCATION
- ALLOCATED PARK
- EPC RATING C
- COUNCIL TAX BAND B
- 12 MONTHS +
- DEPOSIT £1211.00
- AVAILABLE JUNE

A good sized one bedroom ground floor floor flat situated in walking distance of the station and town centre.

Lines & James are pleased to bring this well presented one bedroom flat to the market. Accommodation comprises: Entrance hall with useful storage cupboards. Lounge/diner with attractive bay window, modern fitted kitchen, double bedroom and stylish bathroom with shower over bath. The property also benefits from gas central heating, double glazing and allocated parking.



GROUND FLOOR

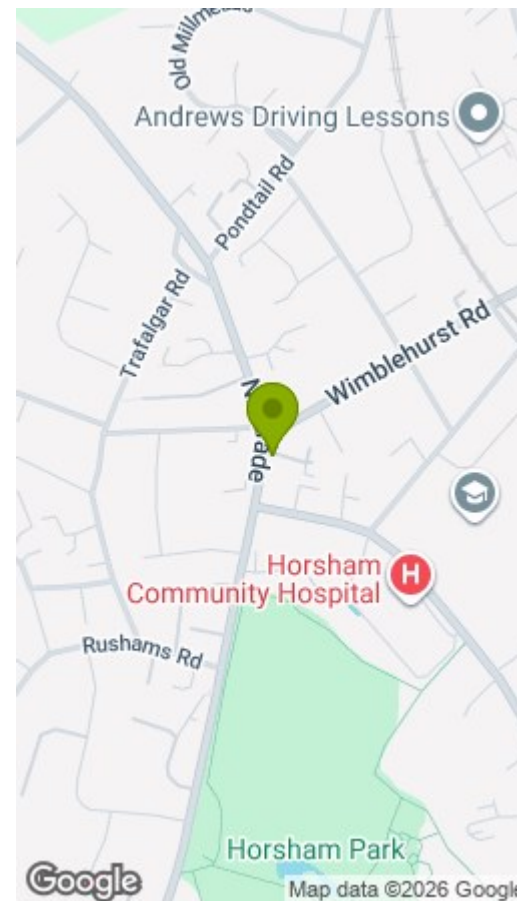
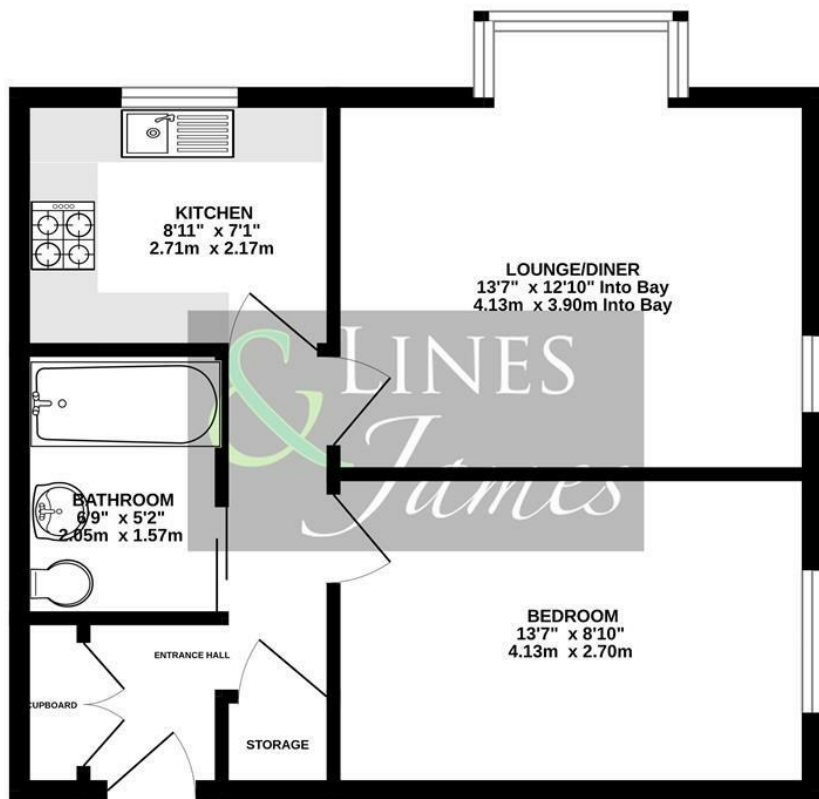

Energy Efficiency Rating	Current	Potential	Environmental Impact (CO <sub>2</sub> ) Rating	Current	Potential
Very energy efficient - lower running costs			Very environmentally friendly - lower CO <sub>2</sub> emissions		
(92 plus) <b>A</b>			(12 plus) <b>A</b>		
(81-91) <b>B</b>			(81-91) <b>B</b>		
(69-80) <b>C</b>			(69-80) <b>C</b>		
(55-68) <b>D</b>			(55-68) <b>D</b>		
(39-54) <b>E</b>			(39-54) <b>E</b>		
(21-38) <b>F</b>			(21-38) <b>F</b>		
(1-20) <b>G</b>			(1-20) <b>G</b>		
Not energy efficient - higher running costs			Not environmentally friendly - higher CO <sub>2</sub> emissions		
<b>England &amp; Wales</b>	EU Directive 2002/91/EC		<b>England &amp; Wales</b>	EU Directive 2002/91/EC	

Measurements are approximate and not to scale. Bedroom measurements do not take into account the fitted wardrobes. This plan is for illustrative purposes only and should only be used as such by any prospective tenant. No responsibility is taken for any error, omission or mis-statement. Made with Metropix ©2026



24 Worthing Road, Horsham, West Sussex, RH12 1SL,  
Tel: 01403 210088  
lettings@linesandjames.com  
www.linesandjames.com

